

VICINITY MAP

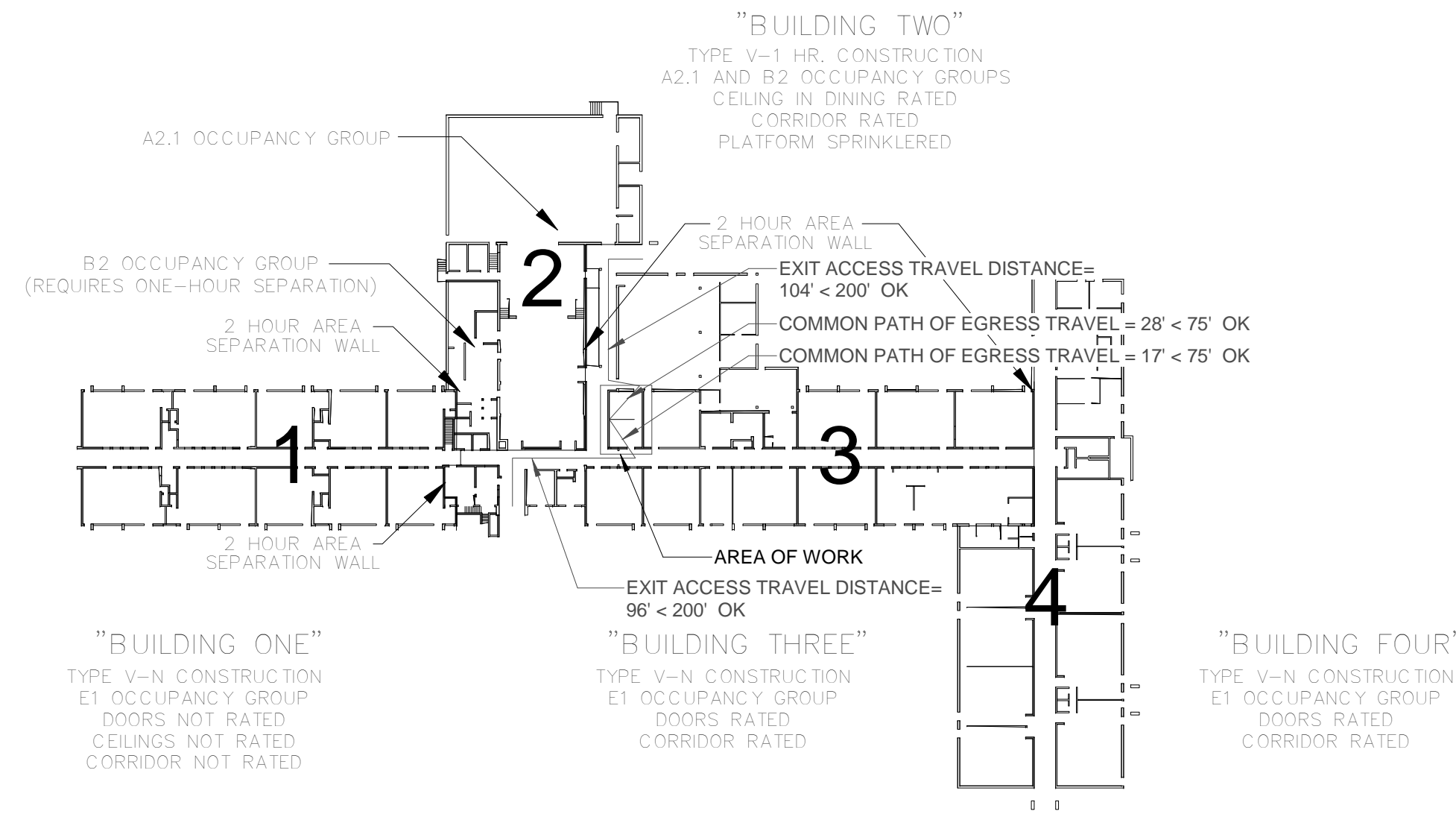

BUILDING INFORMATION	
BUILDING ADDRESS: 810 BROOKSHIRE AVE COLORADO SPRINGS, CO 80905	
SCOPE OF WORK: CONSTRUCT A NEW WALL ACROSS THE EXISTING CORRIDOR TO ACT AS A SECURE BARRIER. THERE WILL BE EXIT DOORS IN THE WALL TO MATCH THE SAME EXIT WIDTH AS THE EXISTING VESTIBULE DOORS.	
EXISTING BUILDING INFORMATION: OVERALL BUILDING SF: 56,893 SF	AREA OF WORK SF: 400 SF
TYPE OF CONSTRUCTION: EXISTING - NO CHANGE. TYPE OF CONSTRUCTION VARIES. SEE ABOVE FOR TYPE OF CONSTRUCTION FOR EACH BUILDING.	
OCCUPANCY: E OCCUPANCY IN AREA OF WORK - NO CHANGE	
FIRE PROTECTION: NON-SPRINKLERED IN AREA OF WORK	
CODE ENFORCED: 2015 IBC	

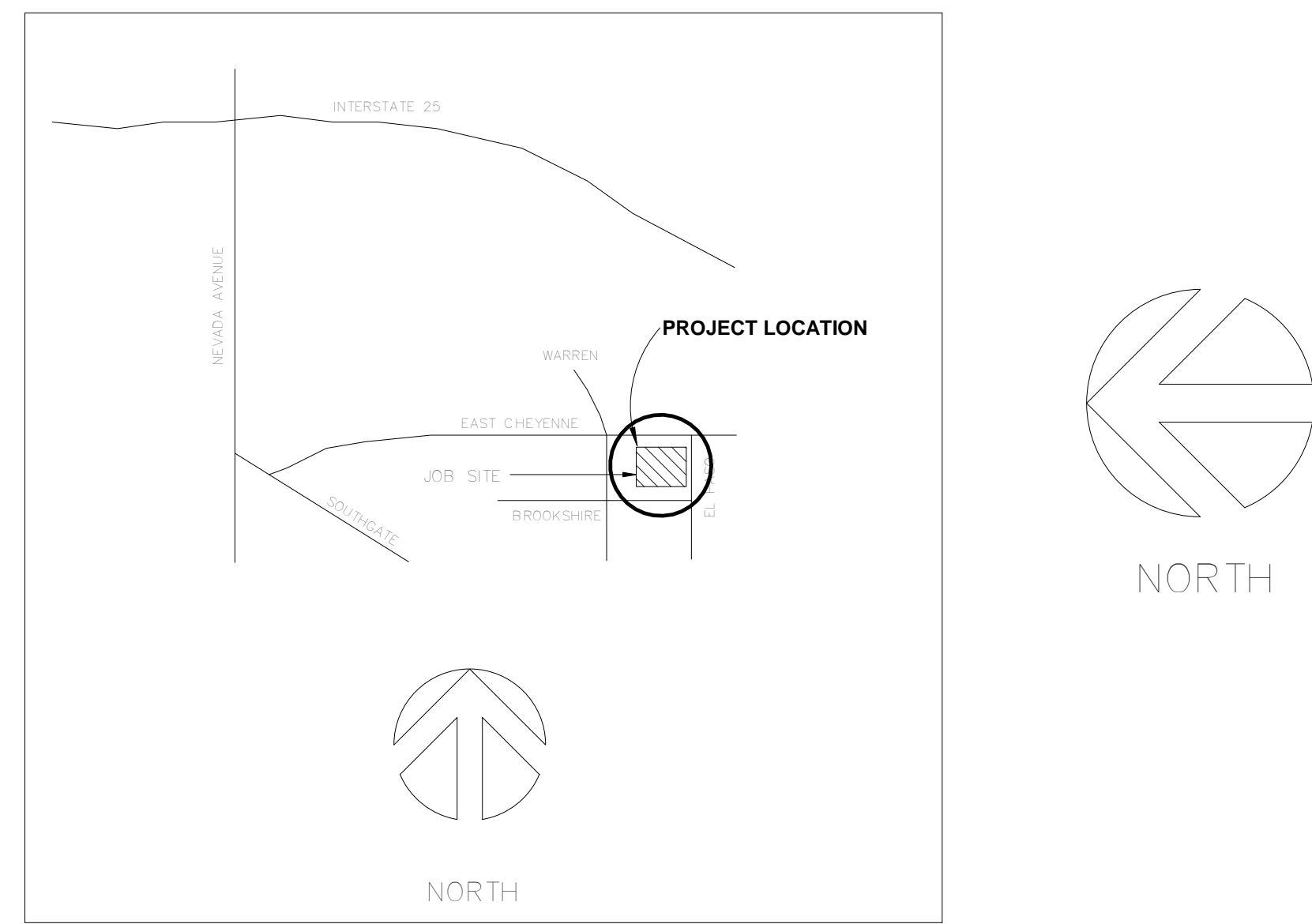
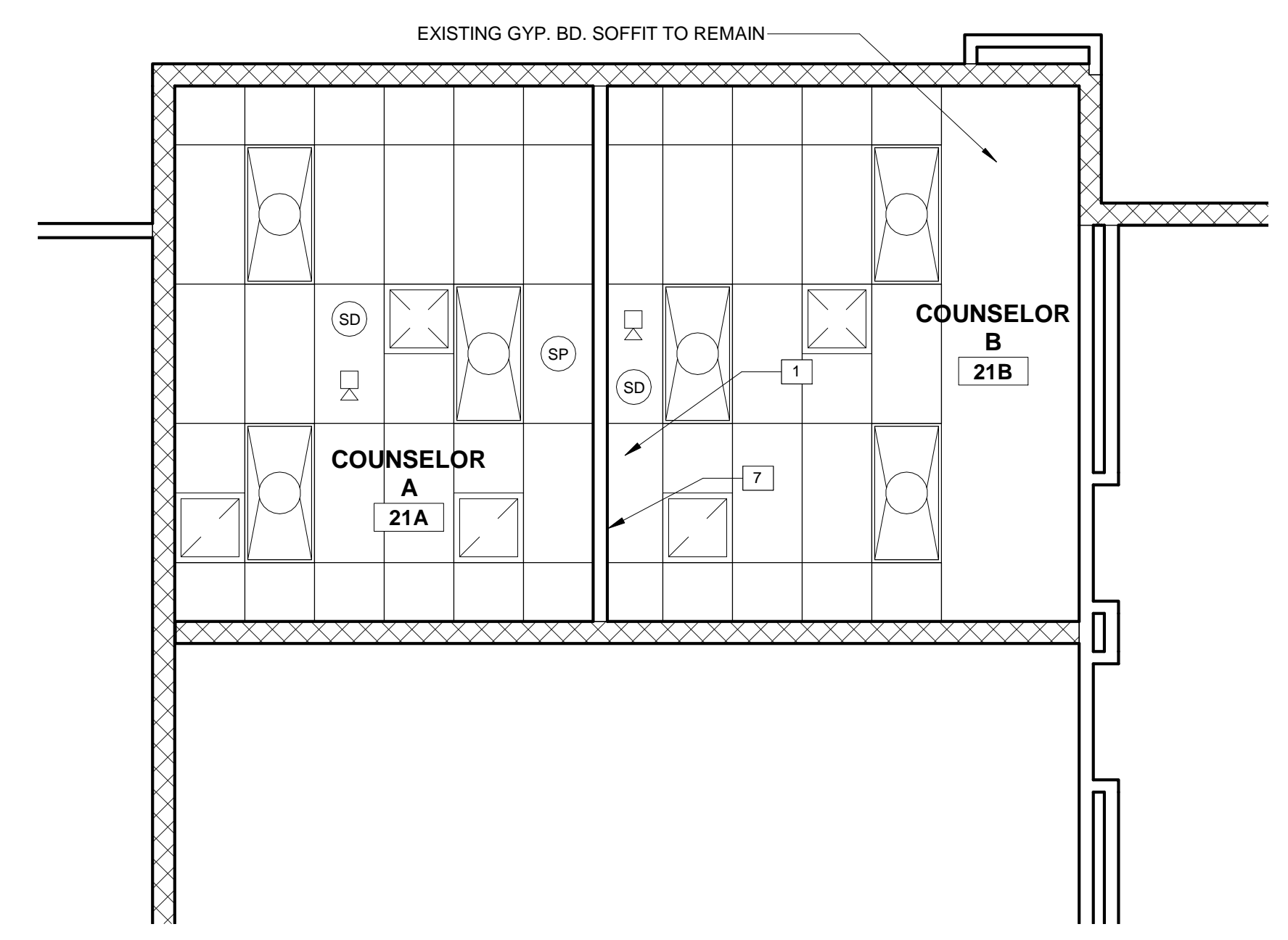

2 PARTIAL REFLECTED CEILING PLAN
CS.02 1/4" = 1'-0"

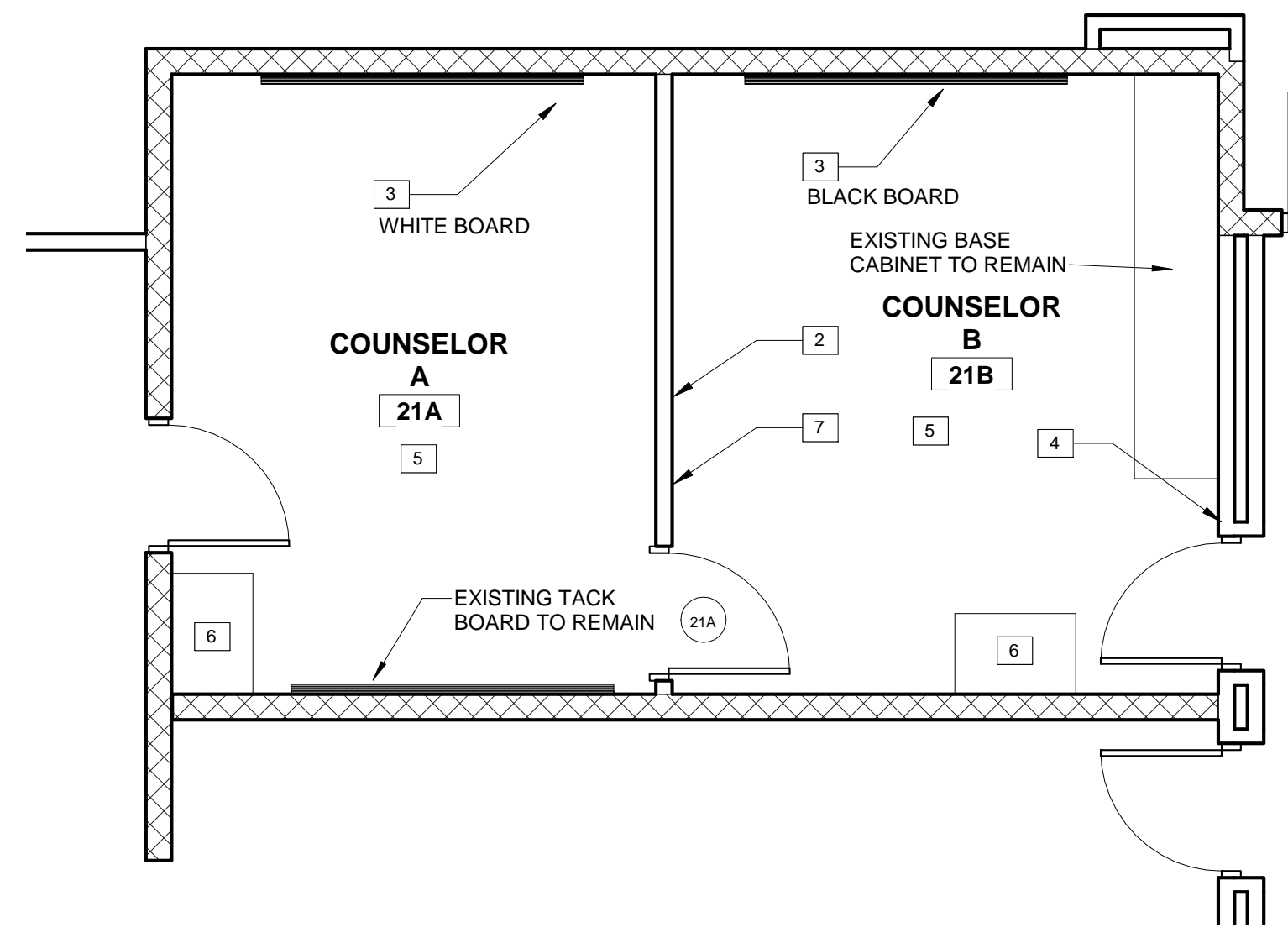

1 PARTIAL FLOOR PLAN
CS.02 1/4" = 1'-0"

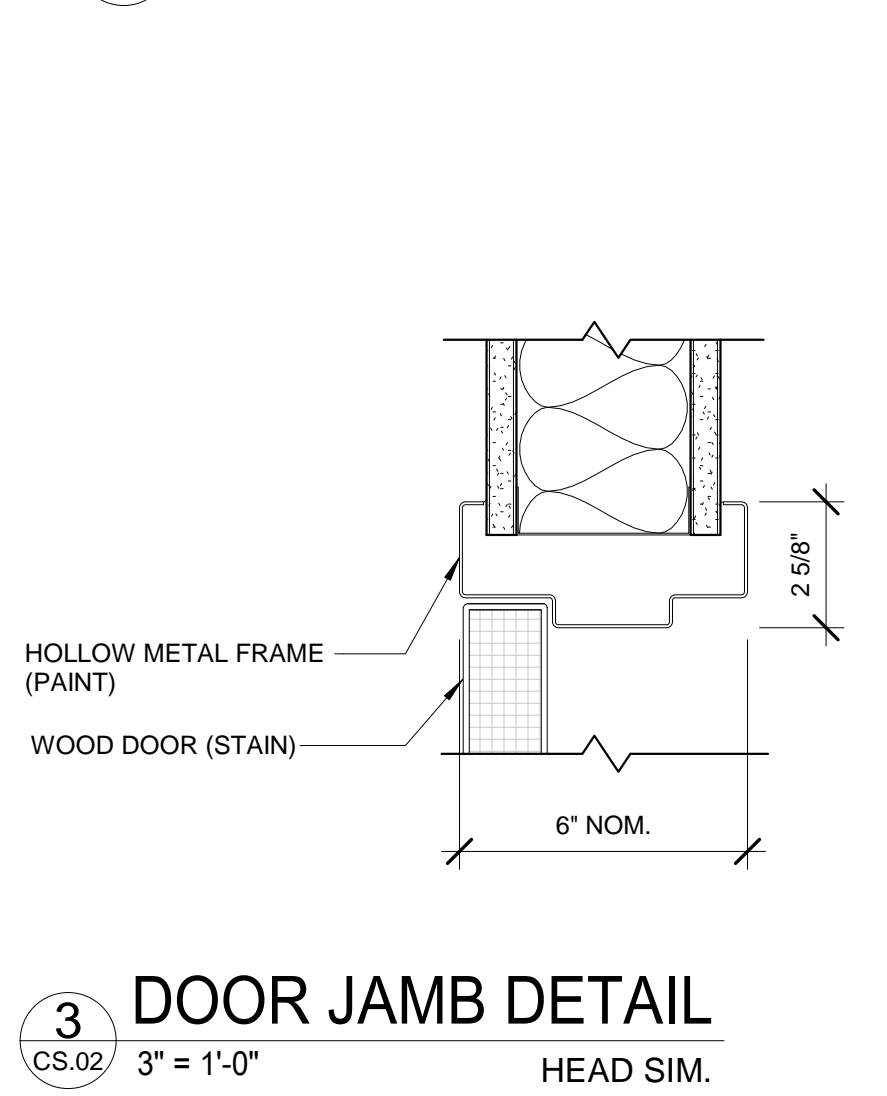

3 DOOR JAMB DETAIL
CS.02 3" = 1'-0"

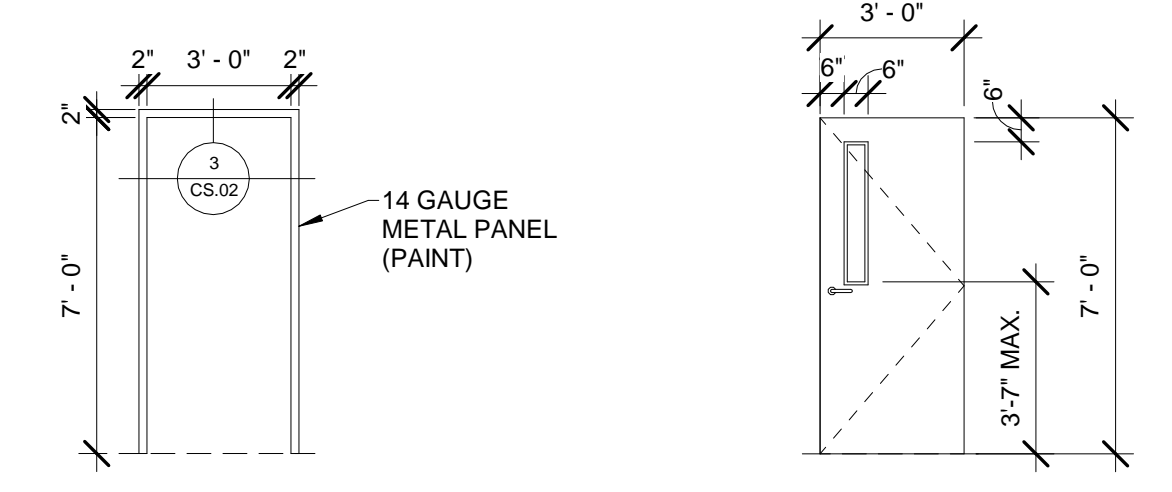

FRAME TYPE
DOOR TYPE

GENERAL DEMOLITION NOTES

DEMOLITION WORK SHALL NOT IMPAIR FIRE AND EMERGENCY ACCESS DRIVES ADJACENT TO THE SITE.

COORDINATE ANY DISRUPTION IN POWER, LIFE SAFETY SYSTEMS, BUILDING ACCESS, MECHANICAL, ELECTRICAL, OR OTHER UTILITIES WITH THE OWNER PRIOR TO WORK. PROVIDE 24 HOUR NOTICE OF ANY UTILITY DISRUPTION.

CONTACT LOCAL FIRE DEPARTMENT WHEN FIRE ALARM WILL BE TAKEN OFF LINE.

PROTECT EXISTING FINISHES TO REMAIN DURING DEMOLITION WORK. CONTRACTOR IS RESPONSIBLE FOR REPAIRING ANY DAMAGE TO EXISTING WORK TO REMAIN.

PROPERLY PROTECT EXISTING EQUIPMENT, FURNISHINGS, AND CASEWORK WHICH IS TO REMAIN DURING DEMOLITION WORK AND CONSTRUCTION.

GENERAL CONTRACTOR TO FIELD VERIFY EXISTING CONDITIONS PRIOR TO CONSTRUCTION.

REFER TO MECHANICAL DRAWINGS FOR EXTENT OF MECHANICAL EQUIPMENT AND SYSTEMS WORK TO REMAIN AND BE MAINTAINED DURING CONSTRUCTION.

REFER TO ELECTRICAL DRAWINGS FOR EXTENT OF ELECTRICAL, LIFE SAFETY, AND CONTROL SYSTEMS WORK TO REMAIN AND BE MAINTAINED DURING CONSTRUCTION.

DISPOSE OF ALL MATERIALS REMOVED LEGALLY OFF-SITE.

CONTRACTOR TO OFFER THE OWNER FIRST RIGHT OF REFUSAL FOR REMOVED EQUIPMENT PRIOR TO DISPOSAL.

REMOVE ONLY PORTION OF WALLS AND CEILINGS REQUIRED FOR DEMOLITION OF BUILDING UTILITIES AND THE INSTALLATION OF NEW WORK. DO NOT DISTURB THE STRUCTURAL INTEGRITY OF THE EXISTING BUILDING.

PATCH WALLS WHERE PORTION OF WALL HAS BEEN REMOVED TO MATCH FACE OF ADJACENT WALL TYPE IN FINISH AND COLOR.

GENERAL BUILDING NOTES

REFER TO MECHANICAL AND ELECTRICAL DRAWINGS FOR BUILDING UTILITY WORK.

INTERIOR DIMENSIONS ARE TO FINISH FACE OF WALL UNLESS OTHERWISE NOTED.

PROVIDE 4" CLEAR BETWEEN FACE OF FINISH WALL AND DOOR FRAME UNLESS OTHERWISE NOTED.

PATCH BACK ANY OPENINGS IN WALL AND CEILING WHERE PIECE OF EQUIPMENT HAS BEEN REMOVED. BUILD BACK TO MATCH ADJACENT CONSTRUCTION TYPE AND FINISH.

PROVIDE FIRE SEALANT TO MATCH WALL RATING BEING APPLIED TO.

PROVIDE SEALANT AT DISSIMILAR MATERIAL JOINTS UNLESS OTHERWISE NOTED.

THE FIRE ALARM SYSTEM FOR THE BUILDING IS TO REMAIN OPERATIONAL DURING THE WORK. CONTRACTOR TO PROVIDE COVERINGS FOR THE LIVE FIRE ALARM SYSTEM DEVICES INCLUDING BUT NOT LIMITED TO SMOKE DETECTORS, HEAT DETECTORS, ETC. THE USE OF LATEX PRODUCTS (LATEX GLOVES THAT ARE NOT POWDERED) IS ALLOWED AS A COVERING. NOT ALL DETECTORS ALLOW THE USE OF THE GLOVES BECAUSE OF THEIR SHAPE SO ALTERNATE METHODS ARE SOMETIMES NEEDED.

UPDATE FIRE ALARM SYSTEM ANNUNCIATOR AND GRAPHICS PANELS WITH NEW ROOM LAYOUT AND NUMBERING.

- BUILDING KEYED NOTES**
- REMOVE PORTION OF GRID FOR NEW WALL CONSTRUCTION. REPLACE GRID AND CEILING TILE ON EACH SIDE OF WALL. REPAIR CEILING GRID AND REPLACE CEILING TILES THAT ARE DAMAGED.
 - INSTALL NEW 3-5/8" METAL STUD WALL WITH 5/8" GYPSUM BOARD ON EACH SIDE TO 6" MIN. ABOVE CEILING. ALIGN FACE OF WALL WITH EDGE OF EXISTING CEILING GRID. BRACE TO STRUCTURE ABOVE. PAINT. INSTALL RUBBER BEE TO MATCH EXISTING BASE IN COLOR AND PROFILE.
 - REMOVE AND RELOCATE MARKER / BLACK / TACK BOARD TO NEW LOCATION. COORDINATE NEW LOCATION WITH OWNER.
 - NEW LIGHT SWITCH. REFER TO ELECTRICAL.
 - REPAINT WALLS IN ROOM. COLOR TO MATCH EXISTING.
 - REMOVE CABINET FROM WALL. PAINT WALL. REINSTALL CABINET WHERE DIRECTED BY OWNER.
 - PROVIDE 3.5" UNFACED BATT INSULATION IN WALL AND EXTEND 4'-0" EACH SIDE OF WALL ON TOP OF CEILING SYSTEM.

DRAWINGS INDEX - ARCHITECTURAL

CS.02 PROJECT PLAN SHEET

DRAWINGS INDEX - ELECTRICAL

E0.01 ELECTRICAL LEGEND
E2.01 ELECTRICAL FLOOR PLAN

DRAWINGS INDEX - MECHANICAL

M2.01 MECHANICAL FLOOR PLAN



OWNER

HARRISON DISTRICT NO. 2
1060 Harrison Road
Colorado Springs, CO 80906



ARCHITECT

CSNA ARCHITECTS
532 Tejon Street
Colorado Springs, CO 80903
719-473-7225



ELECTRICAL ENGINEER

BRIDGERS & PAXTON
1365 Garden of the Gods Rd., Suite 130
Colorado Springs, Colorado 80907



MECHANICAL ENGINEERS

BRIDGERS & PAXTON
1365 Garden of the Gods Rd., Suite 130
Colorado Springs, Colorado 80907

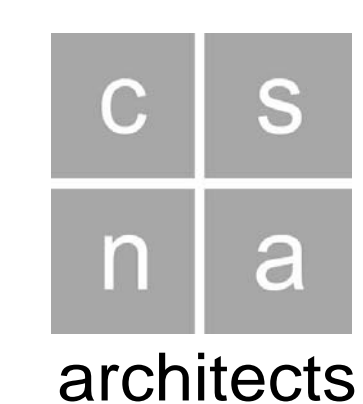

532 n. tejon st. colorado springs co 80903
p: 719.473.7225 f: 719.632.5164 csnaarchitects.com

HARRISON SCHOOL DISTRICT NO. 2

610 Brookshire Ave, Colorado Springs, CO 80905

**STRATTON MEADOWS ELEMENTARY
COUNSELOR OFFICE RENOVATION**

CONSTRUCTION DOCUMENTS

APRIL 18, 2019

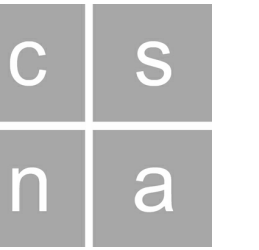

532 n. tejon st.
colorado springs
colorado 80903
p: 719-473-7225
f: 719-632-5164
cnsarchitects.com



1385 Garden of the Gods Rd., Suite 130
Colorado Springs, CO 80907
719.530.3350 www.btpco.com

ELECTRICAL SYMBOL LEGEND (NOT ALL SYMBOLS APPLY TO THIS PROJECT)

UPDATED: 02/26/2018

ABBREVIATIONS

ABBREV.	DEFINITION
A	AMPS, AMPERE AMPERAGE
AC	ABOVE COUNTER
A/C	ALTERNATING CURRENT
ADA	AMERICANS WITH DISABILITIES ACT
AF	ABOVE FINISHED FLOOR
AFG	ABOVE FINISHED GRADE
AIC	AVAILABLE INTERRUPTING CURRENT
AL	ALUMINUM
ANSI	AMERICAN NATIONAL STANDARDS INSTITUTE
ATSC	AUTOMATIC TRANSFER SWITCH CONTROL
ATS	AUTOMATIC TRANSFER SWITCH
AV	AUDIO/VISUAL
AWG	AMERICAN WIRE GAUGE
C	CONDUIT
CB	CIRCUIT BREAKER
CCTV	CLOSED CIRCUIT TELEVISION
CKT	CIRCUIT
CL	CLOCK
CLF	CURRENT LIMITING FUSE
CO	CONDUIT ONLY
CU	COPPER
D	DIMMING
DC	DIRECT CURRENT
DL	DAY-LIGHTING
DIA	DIAMETER
E	EMERGENCY
EC	EMERGENCY, CRITICAL
EG	ENGINE GENERATOR
EL	EMERGENCY, LIFE SAFETY
EQ	EMERGENCY EQUIPMENT
EWC	ELECTRIC WATER COOLER
EX	EXISTING
FUT	FUTURE
FA	FIRE ALARM
FAA	FIRE ALARM ANNUNCIATOR
FACP	FIRE ALARM CONTROL PANEL
FATC	FIRE ALARM TERMINAL CABINET
FDR	FACILITY MANAGEMENT SYSTEM GENERATOR
FMS	FACILITY MANAGEMENT SYSTEM GENERATOR
GF	GROUND FAULT INTERRUPTER
G OR GFCI	GROUND FAULT CIRCUIT INTERRUPTER
GFEP	GROUND FAULT EQUIPMENT PROTECTION
GFPP	GROUND FAULT PROTECTION
GND	GROUND
HQA	HAND-OFF-AUTOMATIC
HP	HORSEPOWER
IEEE	INSTITUTE OF ELECTRICAL AND ELECTRONICS ENGINEERS
IG	ISOLATED GROUND
ICML	THOUSAND CIRCULAR MILS
KV	KILOVOLT
KVA	KILOVOLT AMPS
KVAR	KILOVOLT AMPS REACTIVE
KW	KILOWATT
KWH	KILOWATT HOUR
LSIG	LONG TIME, SHORT TIME, INSTANTANEOUS, AND GROUND FAULT PROTECTION
MAX	MAXIMUM
MCC	MOTOR CONTROL CENTER
MIN	MINIMUM
MH	MANHOLE
MM	MIXED MEDIA
MTS	MANUAL TRANSFER SWITCH
MVA	MEGAVOLT AMPS
N	NOT APPLICABLE
N/A	NORMALLY CLOSED
NEC	NATIONAL ELECTRICAL CODE
NEMA	NATIONAL ELECTRICAL MANUFACTURERS ASSOCIATION
NEUT	NEUTRAL
NFPA	NATIONAL FIRE PROTECTION ASSOCIATION
NIC	NOT IN CONTRACT
NL	NORMAL
NM	NEW MEXICO
NO	NORMALLY OPEN
OH	OVERHEAD
P	POLE
PA	PUBLIC ADDRESS
PC	PHOTOCELL
PH	PHASE
PMCS	POWER MONITORING AND CONTROL SYSTEM
R	REMOVED/REMOVAL
RC	ROOM CONTROLLER
RSC	RIGID STEEL CONDUIT
SEC	SECURITY
SPD	SURGE PROTECTIVE DEVICE
SW	SWITCH
TEMP	TEMPERARY
TTB	TELEPHONE TERMINAL BOARD
TV	TELEVISION
TVSS	TRANSIENT VOLTAGE SURGE SUPPRESSER
TYPC	TYPICAL
UC	UNDER COUNTER
UG	UNDERGROUND
UGE	UNDERGROUND ELECTRIC UNDERWRITERS' LABORATORIES UNLESS OTHERWISE NOTED
UL	UNINTERRUPTIBLE POWER SUPPLY
UON	VOLTS, VOLTAGE
VFD	VARIABLE FREQUENCY DRIVE
W	WALL MOUNTED
WG	WEATHERPROOF AND GFCI
WP	WEATHERPROOF
XFMR	TRANSFORMER
XFMR (TRANSF)	TRANSFORMER

REFERENCE TAGS

SYMBOL	DEFINITION
(N)	KEYED NOTE REFERENCE
(M)	MECHANICAL EQUIPMENT REFERENCE
(+44")	DENOTES MOUNTING HEIGHT AFF
(K)	KITCHEN EQUIPMENT REFERENCE
(L)	MEDICAL EQUIPMENT REFERENCE

GENERAL DRAWING SYMBOLS

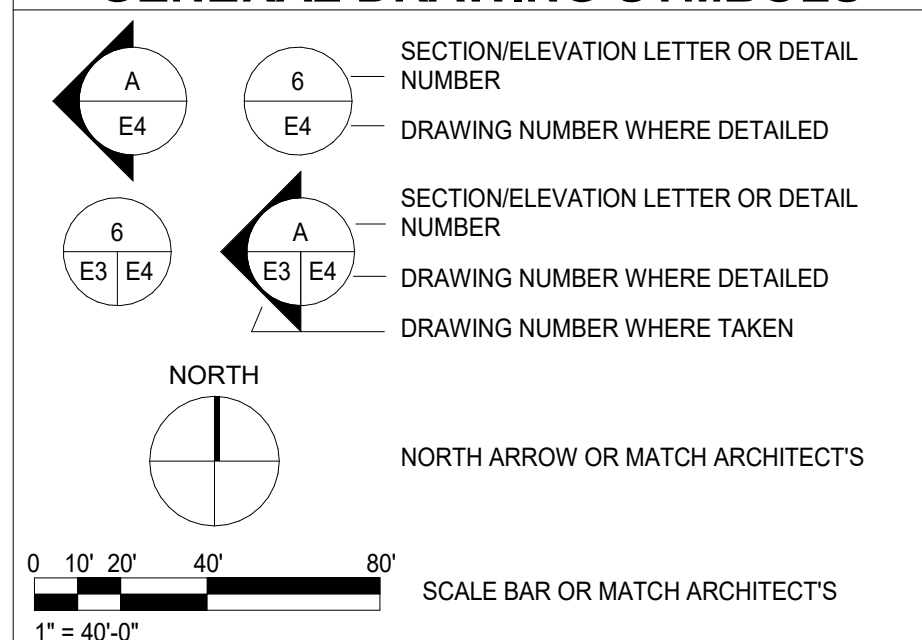

EQUIPMENT NAMING CONVENTION

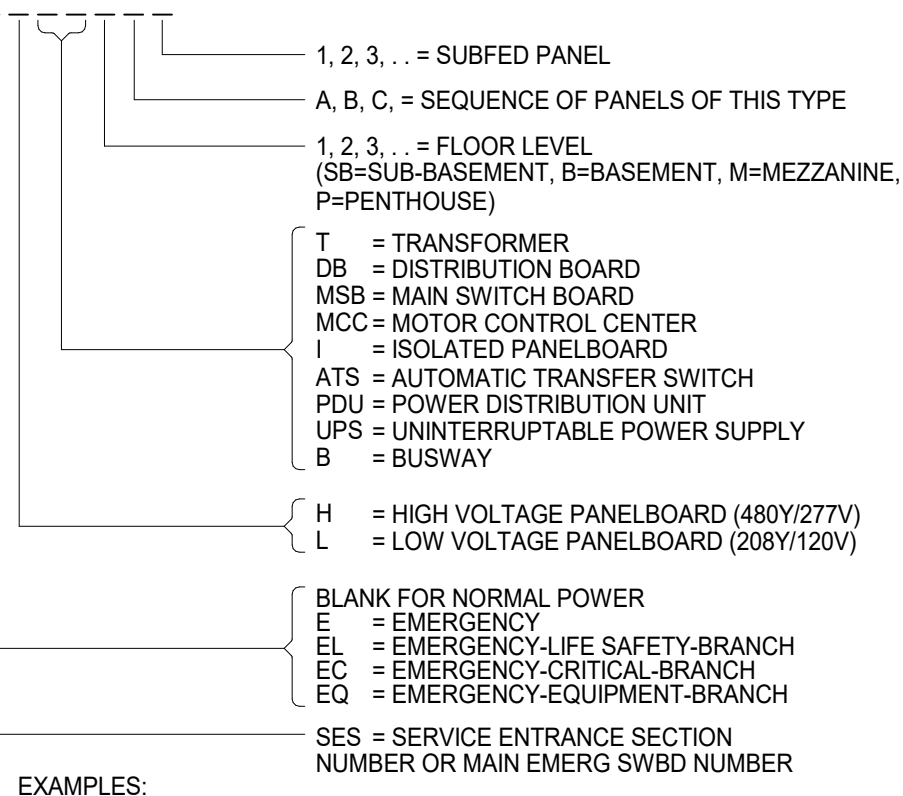

RACEWAY & CONDUCTORS

BRANCH CIRCUIT GENERAL INFORMATION:
BRANCH CIRCUITS FROM OVERCURRENT PROTECTION (20A) TO FURTHEST DEVICE SHALL NOT EXCEED 75 FEET FOR 150 FEET COPPER AND 100 FEET ALUMINUM COPPER, MEASURED ALONG CONDUCTORS ROUTING PATH. BRANCH CIRCUITS EXCEEDING 150 FEET WILL BE SIZED SO THAT VOLTAGE DROP DOES NOT EXCEED 5%.

SYMBOL	DESCRIPTION
○	GROUND
○/	HOT/PHASE
○/○	NEUTRAL
○/○/	SWITCH LEG
LA-1	HOMERUN FROM EQUIPMENT LOCATION. THE CIRCUIT NUMBER ADJACENT TO HOMERUN INDICATES PANEL SOURCE AND INDIVIDUAL SINGLE POLE CIRCUIT BREAKER(S). CONDUCTOR IDENTIFICATION SYMBOL INDICATES NUMBER OF CONDUCTORS IN HOMERUN. MINIMUM #12 CONDUCTORS AND 3/4" RACEWAY PATH WILL BE PROVIDED IN HOMERUN UON. ALL HOMERUNS WILL INCLUDE GROUND CONDUCTOR.
LA-1.3	HOMERUN FROM EQUIPMENT LOCATION. THE CIRCUIT NUMBER ADJACENT TO HOMERUN INDICATES PANEL SOURCE AND INDIVIDUAL SINGLE POLE CIRCUIT BREAKER(S). REPRESENTS A MULTI-BRANCH CIRCUIT. NUMBER OF CONDUCTORS IN HOMERUN WILL INCLUDE A SEPARATE NEUTRAL FOR EACH CIRCUIT PHASE CONDUCTOR. MINIMUM #12 CONDUCTORS AND 3/4" RACEWAY PATH WILL BE PROVIDED IN HOMERUN UON. ALL HOMERUNS WILL INCLUDE GROUND CONDUCTOR.
LA-5,7,9	HOMERUN FROM EQUIPMENT LOCATION. THE CIRCUIT NUMBER ADJACENT TO HOMERUN INDICATES PANEL SOURCE AND INDIVIDUAL TWO OR THREE POLE CIRCUIT BREAKERS. CONDUCTOR IDENTIFICATION SYMBOL INDICATES NUMBER OF CONDUCTORS IN HOMERUN. MINIMUM #12 CONDUCTORS AND 3/4" RACEWAY PATH WILL BE PROVIDED IN HOMERUN UON. NEUTRAL MAY BE USED WHERE INDICATED ON PLAN. ALL HOMERUNS WILL INCLUDE GROUND CONDUCTOR.
LA-7	CONCEALED RACEWAY BETWEEN DEVICES AND/OR EQUIPMENT IN WALLS OR IN CEILING SPACE
LA-13	UNDERGROUND RACEWAY BETWEEN DEVICES AND/OR EQUIPMENT
DOWN	EXPOSED RACEWAY BETWEEN DEVICES AND/OR EQUIPMENT ON WALLS OR CEILINGS
UP	CONDUIT TURNS
B	CONDUIT STUBBED AND CAPPED
G	BUSWAY
T	GROUNDING CONDUCTOR
D	CABLE TRAY - POWER AND TELECOMMUNICATIONS
VID	TELECOMMUNICATIONS RACEWAY
FA	DATA RACEWAY
FA	VOICE/DATA COMBINATION RACEWAY
FA	FIRE ALARM RACEWAY

EQUIPMENT

SYMBOL	DESCRIPTION
MSB	MAIN SWITCHBOARD. DASHED LINES INDICATE CLEARANCES.
DB	DISTRIBUTION BOARD. DASHED LINES INDICATE CLEARANCES.
H1A	FLUSH MOUNTED PANELBOARD. DASHED LINES INDICATE CLEARANCES.
L1A	SURFACE MOUNTED PANELBOARD. DASHED LINES INDICATE CLEARANCES.
MCC	MOTOR CONTROL CENTER. DASHED LINES INDICATE CLEARANCES.
T1A	DRY TYPE TRANSFORMER (15KVA OR ABOVE), WITH EQUIPMENT TAG (TAG INSIDE OR OUTSIDE, DEPENDING ON SIZE). IN MOST CASES, ACTUAL SIZE SHOWN ON PLANS (ELECTRICAL ROOMS).
T	DRY TYPE TRANSFORMER (LESS THAN 15KVA), WITH NO EQUIPMENT TAG. SIZE, TYPE AND LOCATION NOTED ON PLANS.
VFD	VARIABLE FREQUENCY DRIVE
UPS-A	UNINTERRUPTIBLE POWER SUPPLY. DASHED LINES INDICATE CLEARANCES.
ATS-1	AUTOMATIC TRANSFER SWITCH. DASHED LINES INDICATE CLEARANCES.
G	GROUND BAR

DEMOLITION

SYMBOL	DESCRIPTION	NOTES
○/○/	DASHED SYMBOL INDICATES EXISTING DEVICE OR EQUIPMENT TO BE REMOVED	
○/○/	REMOVE EXISTING RACEWAY IN ALL ACCESSIBLE AREAS. CAPPED AND ABANDONED IF IN UNACCESSIBLE AREA	REFER TO DEMOLITION PLANS FOR ADDITIONAL INFORMATION
○/○/	SOLID SYMBOL, LIGHTER IN COLOR INDICATES EXISTING DEVICE OR EQUIPMENT TO REMAIN	
EX	EXISTING CONDUIT TO BE REUSED	

DEVICES

SYMBOL	DESCRIPTION	LOC.	MOUNTING HT.
○	BLANK FOR NORMAL POWER (TYPICAL FOR MOST RECEPTACLE TYPES) G = GFCI RATED IG = ISOLATED GROUND T = TAMPERPROOF WG = WEATHERPROOF AND GFCI WP = WEATHERPROOF (IN-USE COVER) CL = CLOCK TV = TELEVISION		
○	FLOOR BOX DUPLEX RECEPTACLE. WIREMOLD #RFB CONFIGURATION AS INDICATED ON PLANS	FLOOR	VARIES
○	FLOOR BOX DOUBLE DUPLEX RECEPTACLE. WIREMOLD #RFB CONFIGURATION AS INDICATED ON PLANS	FLOOR	VARIES
○	N FLOOR EMERGENCY DUPLEX RECEPTACLE. CONFIGURATION AS INDICATED ON PLANS	FLOOR	VARIES
○	N FLOOR EMERGENCY DOUBLE DUPLEX (QUADPLEX) RECEPTACLE. CONFIGURATION AS INDICATED ON PLANS	FLOOR	VARIES
○	POKE THROUGH FLOOR DUPLEX RECEPTACLE. WIREMOLD #RATCP	FLOOR	VARIES
○	POKE THROUGH COMBINATION AMPERAGE/COMMUNICATION FLOOR OUTLET. WIREMOLD #RATCP**	FLOOR	VARIES
○	CEILING MOUNTED DUPLEX RECEPTACLE	CEILING	FLUSH
○	CEILING MOUNTED DOUBLE DUPLEX (QUADPLEX) RECEPTACLE	CEILING	FLUSH
○	CEILING MOUNTED EMERGENCY DUPLEX RECEPTACLE	CEILING	FLUSH
○	CEILING MOUNTED EMERGENCY DOUBLE DUPLEX (QUADPLEX) RECEPTACLE	CEILING	FLUSH
○	COMBINATION POWER/COMMUNICATION IN CEILING OUTLET. CONFIGURATION AS INDICATED ON PLANS	CEILING	FLUSH
○	SIMPLEX RECEPTACLE		
○	DUPLEX RECEPTACLE		
○	DOUBLE DUPLEX (QUADPLEX) RECEPTACLE SPLIT DUPLEX RECEPTACLE. TOP HALF SWITCHED WITH BOTTOM HALF CONTINUALLY HOT.	WALL	+18" UON
○	EMERGENCY DUPLEX RECEPTACLE		
○	EMERGENCY DOUBLE DUPLEX (QUADPLEX) RECEPTACLE		
○	SPECIAL PURPOSE RECEPTACLE. NEMA CONFIGURATION AND AMPERAGE AS NOTED ON PLANS		
○	TVSS RECEPTACLE/TV BOX COMBO PASS & SEYMOUR #TV1WTVSS*	WALL	+60" UON
○	MULTI-OUTLET ASSEMBLY (SURFACE MOUNTED RACEWAY)	VARIES	VARIES
○	COMBINATION POWER/COMMUNICATION POLE. CONFIGURATION AS NOTED ON PLANS	VARIES	VARIES
○	WALL MOUNTED CODE SIZE J-BOX	VARIES	VARIES
○	CODE SIZE JUNCTION BOX	VARIES	VARIES
○	CODE SIZE PULLBOX (OR AS SIZED ON PLAN)	VARIES	VARIES
○	PUSHBUTTON (EMERGENCY POWER OFF - EPO)		
○	PHOTOCELL		
○	LIGHTNING PROTECTION AIR TERMINAL	ROOF	VARIES
○	THERMOSTAT	WALL	+44" UON
○	ENCLOSED CIRCUIT BREAKER. AMPERAGE/NEMA ENCLOSURE RATING, 3 POLE UON		
○	NON-FUSED DISCONNECT SWITCH. AMPERAGE/NEMA ENCLOSURE RATING, 3 POLE UON		
○	FUSED DISCONNECT SWITCH. AMPERAGE/NEMA ENCLOSURE RATING, 3 POLE UON	VARIES	VARIES
○	MOTOR STARTER. STARTER SIZE INDICATED BY NUMBER/NEMA ENCLOSURE RATING, SINGLE SPEED UON	N/A	N/A
○	COMBINATION FUSIBLE DISCONNECT SWITCH AND MOTOR STARTER. NEMA STARTER SIZE/AMPERAGE/NEMA ENCLOSURE RATING, 3 POLE UON		
○	MOTOR. NUMBER INDICATES HORSEPOWER RATING FOR 1HP AND LARGER		
○	MOTOR. "F" INDICATES FRACTIONAL HORSEPOWER		

UTILITIES

SYMBOL	DESCRIPTION
○	DISTRIBUTION POLE FOR OVERHEAD ELECTRICAL OR COMMUNICATIONS AS INDICATED ON PLAN
○	OVERHEAD UTILITY AND/OR SYSTEM DISTRIBUTION.
○	3 = THREE PHASE 1 = SINGLE PHASE
○	P = ELECTRICAL PRIMARY S = ELECTRICAL SECONDARY T = TELECOMMUNICATION
○	TV = TELEVISION
○	E = EMERGENCY POWER
○	ATS = AUTOMATIC TRANSFER SWITCH CONTROL
○	N = NEW
○	EX = EXISTING
○	UNDERGROUND UTILITY AND/OR SYSTEM DISTRIBUTION.
○	UTILITY OR FACILITY TRANSFORMER
○	PAD MOUNTED SWITCH
○	CONNECTION CABINET (UTILITY METER MOUNT)
○	PRIMARY SITE METER ENCLOSURE
○	METER ENCLOSURE. EITHER ON BUILDING OR ON UTILITY EQUIPMENT
○	CT ENCLOSURE. EITHER ON BUILDING OR ON UTILITY EQUIPMENT
○	MANHOLE - POWER OR COMMUNICATION AS INDICATED ON PLANS
○	HAND HOLE - POWER OR COMMUNICATION AS INDICATED ON PLANS
○	ENGINE GENERATOR
○	TELECOMMUNICATION PEDESTAL
○	TELEVISION PEDESTAL

LIGHTING

SYMBOL	DESCRIPTION	LOC.	MOUNTING HT.
○	HATCHING INDICATES EMERGENCY LIGHTING. HATCH TO BE MODIFIED FOR EACH LUMINAIRE TYPE. EMERGENCY LUMINAIRE DESIGNATED WITH "E" IN TYPE DESIGNATION.		
○	RECESSED MOUNTED LUMINAIRE. SMALL CASE "a" DENOTES SWITCHING. SYMBOL "A" DENOTES LUMINAIRE TYPE		
○	SURFACE MOUNTED LUMINAIRE. LUMINAIRE TYPE AS INDICATED ON PLANS	CEILING	
○	LINEAR DIRECT/INDIRECT LUMINAIRE. CABLE OR STEM MOUNTED		
○	DOWN LIGHT LUMINAIRE. CEILING MOUNTED		
○	WALL MOUNTED LUMINAIRES	WALL	
○	TRACK MOUNTED LUMINAIRES	SURFACE	
○	STRIP LUMINAIRE		
○	EXIT LUMINAIRE. SHADED SIDE INDICATES FACE SIDE. PROVIDE DIRECTIONAL ARROW(S) AS INDICATED ON PLANS		
○	DOUBLE FACE EXIT LUMINAIRE. SHADED SIDE INDICATES FACE SIDE. PROVIDE DIRECTIONAL ARROW(S) AS INDICATED ON PLANS		
○	EMERGENCY BATTERY PACK LUMINAIRE (BUG-EYE/FROG-EYE)		
○	SINGLE HEAD, POLE MOUNTED LUMINAIRE	EXTERIOR	AS DETAILED
○	DOUBLE HEAD, POLE MOUNTED LUMINAIRE		
○	DEVICE INDICATOR LETTER "X" EQUALS DESIGNATION BELOW (TYPICAL FOR MOST SWITCH TYPES) a = SMALL CASE LETTER DENOTES SWITCHING CONTROL 2 = DOUBLE POLE TOGGLE SWITCH 3 = THREE-WAY TOGGLE SWITCH 4 = FOUR-WAY TOGGLE SWITCH P = PILOT LIGHT TOGGLE SWITCH M = MOMENTARY CONTACT SWITCH K = KEY OPERATED SWITCH WP = WEATHERPROOF TOGGLE SWITCH T = MANUAL MOTOR STARTER SWITCH WITH THERMAL OVERLOAD PROTECTION D = DIMMER SWITCH WATTSTOPPER ADW=100 DUAL TECHNOLOGY DUAL RELAY WALL SWITCH SENSOR (SINGLE LEVEL SWITCHING) VACANCY SENSOR SWITCH. WATTSTOPPER BOW-TWO DUAL TECHNOLOGY DUAL RELAY WALL SWITCH SENSOR (B-LEVEL SWITCHING)	WALL	+44" UON
○	OCCUPANCY SENSOR, DUAL TECHNOLOGY: WATTSTOPPER #D1-300		
○	OCCUPANCY DIRECTIONAL SENSOR. WATTSTOPPER #D1-200		
○	DIMMING DAY-LIGHTING SENSOR. WATTSTOPPER #LS-301		
○	POWER PACK. WATTSTOPPER# BZ-50	CEILING	SURFACE

ONE-LINE DIAGRAM

SYMBOL	DESCRIPTION
○	CIRCUIT BREAKER; TRIP SETTING/FRACTION SIZE OR NO. OF POLES. SETTINGS AND PROTECTION AS NOTED ON PLANS
○	DRAWOUT CIRCUIT BREAKER (TRIP SETTING, FRAME SIZE)
○	MEDIUM VOLTAGE DRAWOUT CIRCUIT BREAKER (TRIP SETTING, FRAME SIZE)
○	TRANSFORMER. TRANSFORMER NAME, TRANSFORMER KVA RATING, PRIMARY VOLTAGE AND WIRING CONFIGURATION, SECONDARY VOLTAGE, K RATINGS (IF APPLICABLE)
○	CURRENT TRANSFORMER, NUMBER "3000/5" DENOTES RATIO.
○	POTENTIAL TRANSFORMER
○	DISCONNECT SWITCH. "300A" DENOTES AMPERAGE RATING
○	FUSE. "300A" DENOTES AMPERAGE RATING
○	GROUND FAULT PROTECTION
○	SHUNT TRIP OPERATOR
○	GROUND CONNECTION
○	TRANSFER SWITCH. SEE PLANS FOR TYPE OF SWITCH
○	SURGE ARRESTOR
○	SURGE PROTECTIVE DEVICE
○	KILOWATT METER
○	ELECTRONIC METER
○	IRK KEY INTERLOCK No.1
○	RELAY No.1
○	AMMETER SWITCH
○	AMMETER
○	VOLTMETER SWITCH
○	VOLTMETER
○	DELTA CONNECTED
○	WYE CONNECTED
○	GENERATOR
○	VFD CONNECTION
○	MOTOR CONNECTION
○	UPS

FIRE ALARM

SYMBOL	DESCRIPTION	LOC.	MOUNTING HT.
○	FIRE ALARM CONTROL PANEL		
○	FIRE ALARM TERMINAL CABINET (EQUIPMENT NAMING CONVENTION PER PLANS)	WALL	-
○	FIRE ALARM ANNUNCIATOR PANEL		
○	PULL STATION	WALL	+44"
○	FIREMAN'S TELEPHONE OUTLET		
○	HORN NOTIFICATION		
○	SPEAKER NOTIFICATION		
○	CHIME NOTIFICATION		
○	COMBINATION SPEAKER AND CHIME NOTIFICATION	WALL	+80" UON
○	SPEAKER/HORN WITH STROBE LIGHT		
○	STROBE LIGHT ONLY		
○	BELL (GONG)		
○	PHOTOELECTRIC SMOKE DETECTOR		
○	IONIZATION SMOKE DETECTOR		
○	COMBINATION RATE OF RISE / FIXED TEMPERATURE	CEILING	SURFACE
○	FIXED TEMPERATURE. TEMPERATURE AS NOTED ON PLANS OR SPECIFICATIONS		
○	RATE OF RISE ONLY		
○	BEAM TRANSMITTER	CEILING OR WALL	VARIES
○	BEAM RECEIVER		
○	UNDER FLOOR SMOKE DETECTOR	UNDER FLOOR	SEE PLANS
○	DUCT DETECTOR	AT DUCT	SEE PLANS
○	FIRE/SMOKE DAMPER		
○	PRESSURE SWITCH		
○	TAMPER SWITCH		
○	FLOW SWITCH	PIPE	VARIES
○	POST INDICATOR VALVE		
○	MAGNETIC DOOR HOLDER		
○	CONTROL RELAY	VARIES	SEE PLANS
○	MONITOR MODULE		
○	REMOTE ALARM INDICATING LIGHT		
○	ADDRESSABLE/SUPERVISED RELAY		

SPECIAL SYSTEMS

SYMBOL	DESCRIPTION	LOC.	MOUNTING HT.
○	4 PORT FLOOR BOX WITH POWER AND DATA	FLOOR	VARIES
○	4 PORT FLOOR BOX WITH AV. REFER TO J-BOX SCHEDULE ON 600 SERIES SHEETS.	FLOOR	VARIES
○	2 PORT VOICEDATA OUTLET	WALL	+18" UON
○	2 PORT VOICEDATA OUTLET. STUB A 1" CONDUIT 6" INTO CEILING SPACE	WALL	+18" UON
○	2 PORT VOICEDATA OUTLET ABOVE COUNTER TOP	WALL	+44" UON
○	TELEPHONE OUTLET WALL MOUNTED	WALL	+44" UON
○	INTERCOM CALL SWITCH	WALL	+44" UON
○	INTERCOM MASTER STATION		
○	COMMUNICATION HORN	WALL	+84" UON
○	COMMUNICATION BELL	WALL	+108 UON
○	WALL SPEAKER		
○	DURESS ALARM PUSHBUTTON	WALL	SEE PLANS
○	LOCK DOWN PUSHBUTTON		
○	AV JUNCTION BOX. REFER TO J-BOX SCHEDULE ON 600 SERIES SHEETS.	WALL	SEE PLANS
○	AV J-BOXES STACKED VERTICALLY. REFER TO J-BOX SCHEDULE ON 600 SERIES SHEETS.		
○	COMBINATION CLOCKS/SPEAKER. MOUNTED ABOVE AND CENTER TO WRITING/TACK BOARD	WALL	SEE PLANS
○	DIGITAL SIGNAGE VIDEO DISPLAY	WALL	SEE PLANS
○	VIDEO PROJECTOR		REFER TO PLANS
○	CEILING SPEAKER. LOCAL SOUND SYSTEM	CEILING	FLUSH
○	CEILING SPEAKER. INTERCOM SYSTEM		
○	CABLE TRAY FOR COMMUNICATIONS		
○	J-HOOK ROUTING PATH		
○	2 PORT CEILING MOUNTED VOICE/DATA OUTLET	ABOVE CEILING	SEE PLANS
○	WIRELESS ACCESS POINT		
○	CEILING MOUNTED AV JUNCTION BOX. REFER TO J-BOX SCHEDULE ON 600 SERIES SHEETS.		

SECURITY

SYMBOL	DESCRIPTION	LOC.	MOUNTING HT.
○	CARD READER	WALL	+44" UON
○	KEY PAD		
○	EXTERIOR SECURITY CAMERA	VARIES	SEE PLANS
○	INTERIOR SECURITY CAMERA	VARIES	SEE PLANS
○	INTERIOR SECURITY CAMERA 180°		
○	INTERIOR SECURITY CAMERA 360°		
○	GLASS BREAK DETECTOR	WINDOW	SEE PLANS
○	MOTION DETECTOR	CEILING	SEE PLANS
○	DOOR SWITCH		
○	E		

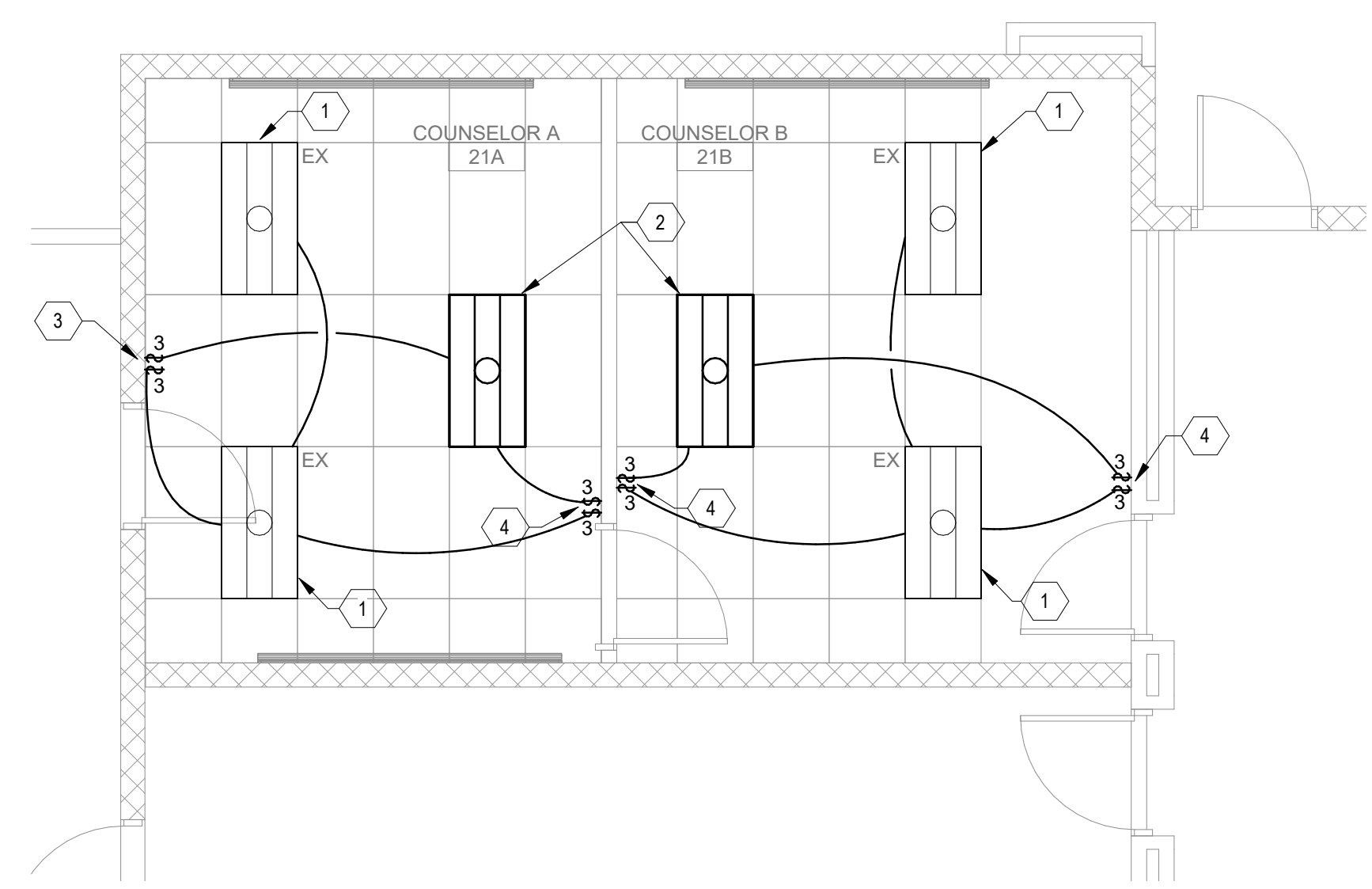

A1
E2.01
LIGHTING FIRST FLOOR PLAN
1/4" = 1'-0"

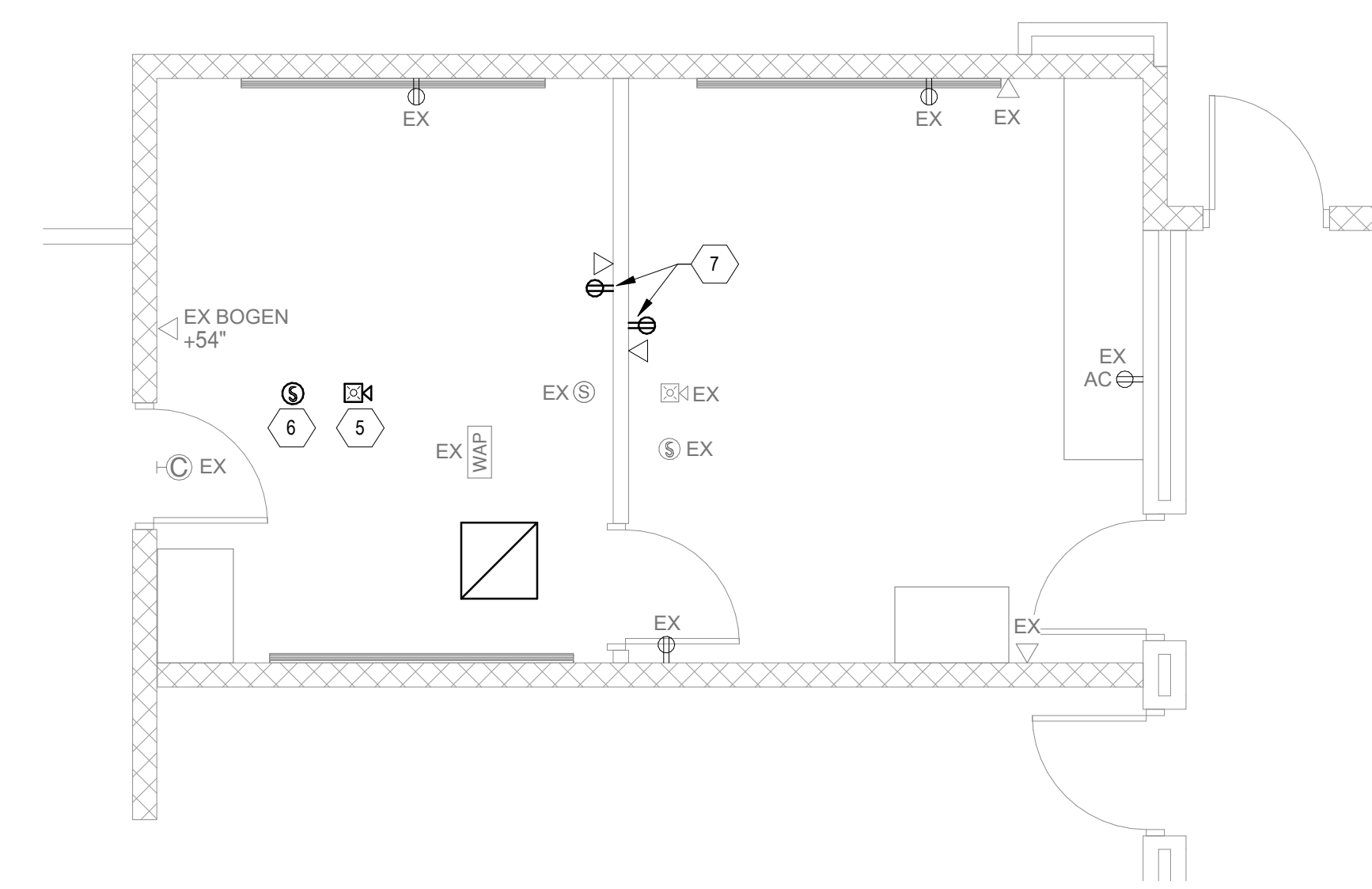
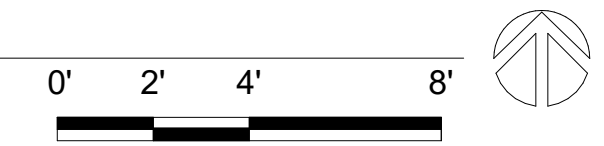

A2
E2.01
POWER FIRST FLOOR PLAN
1/4" = 1'-0"



**STRATTON MEADOWS ELEMENTARY
COUNSELOR OFFICE RENOVATION**
HARRISON SCHOOL DISTRICT NO. 2

REVISIONS

GENERAL SHEET NOTES	KEYNOTES
<p>A. PROVIDE 3 WAY SWITCHING CONTROLS AS REQUIRED.</p> <p>B. ON WALLS BETWEEN ADJACENT OFFICES, INSTALL POWER AND DATA OUTLETS STAGGARED TO PREVENT SOUND TRANSMISSION BETWEEN OFFICES.</p> <p>C. FOR DATA/TELECOMMUNICATION PORTS, PROVIDE 1" EMT STUB UP TO NEAREST ACCESSIBLE CEILING SPACE.</p> <p>D. ALL CONDUIT PATHWAYS SHALL BE PROVIDED WITH NYLON BUSHINGS TO PROTECT CABLES, REGARDLESS OF WHETHER THEY TERMINATE IN A DEVICE OR JUNCTION BOX.</p> <p>E. GROUP DATA OUTLETS WITH POWER OUTLETS.</p>	<p>1. PROVIDE NEW LAMPS IN EXISTING LIGHT FIXTURES. LIGHT COLOR TO MATCH EXISTING.</p> <p>2. RELOCATE EXISTING LIGHT FIXTURE. PROVIDE NEW LAMPS, LIGHT COLOR TO MATCH EXISTING.</p> <p>3. REPLACE LIGHT SWITCHES WITH NEW SWITCHES. PROVIDE NEW SWITCH PATTERN TO CONTROL COUNSELOR A ROOM. INTERCEPT AND EXTEND EXISTING CIRCUITS.</p> <p>4. PROVIDE SWITCHING TO CONTROL COUNSELOR ROOM LIGHTING. INTERCEPT AND EXTEND EXISTING CIRCUITS.</p> <p>5. PROVIDE NEW FIRE ALARM AUDIOVISUAL DEVICE. MATCH EXISTING.</p> <p>6. PROVIDE NEW FIRE ALARM DETECTING DEVICE. MATCH EXISTING.</p> <p>7. PROVIDE POWER TO DUPLEX RECEPTACLE FROM NEAREST AVAILABLE CIRCUIT. VERIFY CIRCUIT CAN ADD ANOTHER DUPLEX RECEPTACLE USING 360VA AS THE POWER REQUIREMENTS FOR THE NEW RECEPTACLE. UPDATE CIRCUIT DIRECTORY AS REQUIRED.</p>

ELECTRICAL FLOOR PLAN

JOB NO.: 1900219
DATE: APRIL 19, 2019

DRAWN: HJP

CHECKED: JDB

E2.01

Copyright © 2019 CSNA Architects

ABBREVIATIONS

ACU	AIR CONDITIONING UNIT
AD	ACCESS DOOR
AFF	ABOVE FINISHED FLOOR
AHU	AIR HANDLING UNIT
AL	ACOUSTIC LINING
BHP	BRAKE HORSEPOWER
BOD	BOTTOM OF DUCT
BOP	BOTTOM OF PIPE
BTU	BRITISH THERMAL UNIT
BTUH	BTU PER HOUR
CA	COMPRESSED AIR
CD	CONDENSATE DRAIN
CFM	CUBIC FEET PER MINUTE
CONT.	CONTINUATION
D	DRAIN
DX	DIRECT EXPANSION
ENT	ENTERING
EXH	EXHAUST
EMCS	ENERGY MANAGEMENT CONTROL SYSTEM
F	DEGREES FAHRENHEIT
FB	FLAT BOTTOM
FCU	FAN COIL UNIT
FD	FLOOR DRAIN
F.G.	FILTER GAUGE
FLEX	FLEXIBLE
FPM	FEET PER MINUTE
FS	FLOOR SINK
FT	FLAT TOP
FT.	FEET
GPH	GALLONS PER HOUR
GPM	GALLONS PER MINUTE
HB	HOSE BIBB
HD	HAND DAMPER (VOLUME DAMPER)
HEPA	HIGH EFFICIENCY PARTICULATE AIR (FILTER)
IN	INCHES
KW	KILOWATT
KWH	KILOWATT HOUR
MA	MAIN AIR (CONTROLS)
MCC	MOTOR CONTROL CENTER
NA	NOT APPLICABLE
NIC	NOT IN CONTRACT
NO.	NUMBER (QUANTITY)
OA	OUTSIDE AIR
OBD	OPPOSED BLADE DAMPER
PRV	PRESSURE REDUCING VALVE
PSIG	POUNDS PER SQUARE INCH GAGE
QTY	QUANTITY
QUAD	QUADRANT
R.A.	RETURN AIR
Rh	RELATIVE HUMIDITY
RPM	REVOLUTIONS PER MINUTE
SCD	SMOKE CONTROL DAMPER
SP	STATIC PRESSURE (INCHES OF WATER)
SDV	SINGLE DUCT VARIABLE VOLUME
ST	SOUND TRAP
TOPT	TOP OF PIPE TRAPEZE
TP	TOTAL PRESSURE (INCHES OF WATER)
TYP.	TYPICAL
V	VOLTS
VAC	VOLTS, ALTERNATING CURRENT
VAV	VARIABLE AIR VOLUME
VEL	VELOCITY
VTR	VENT THRU ROOF

MECHANICAL SYMBOL LEGEND

DUCTWORK SYMBOLS

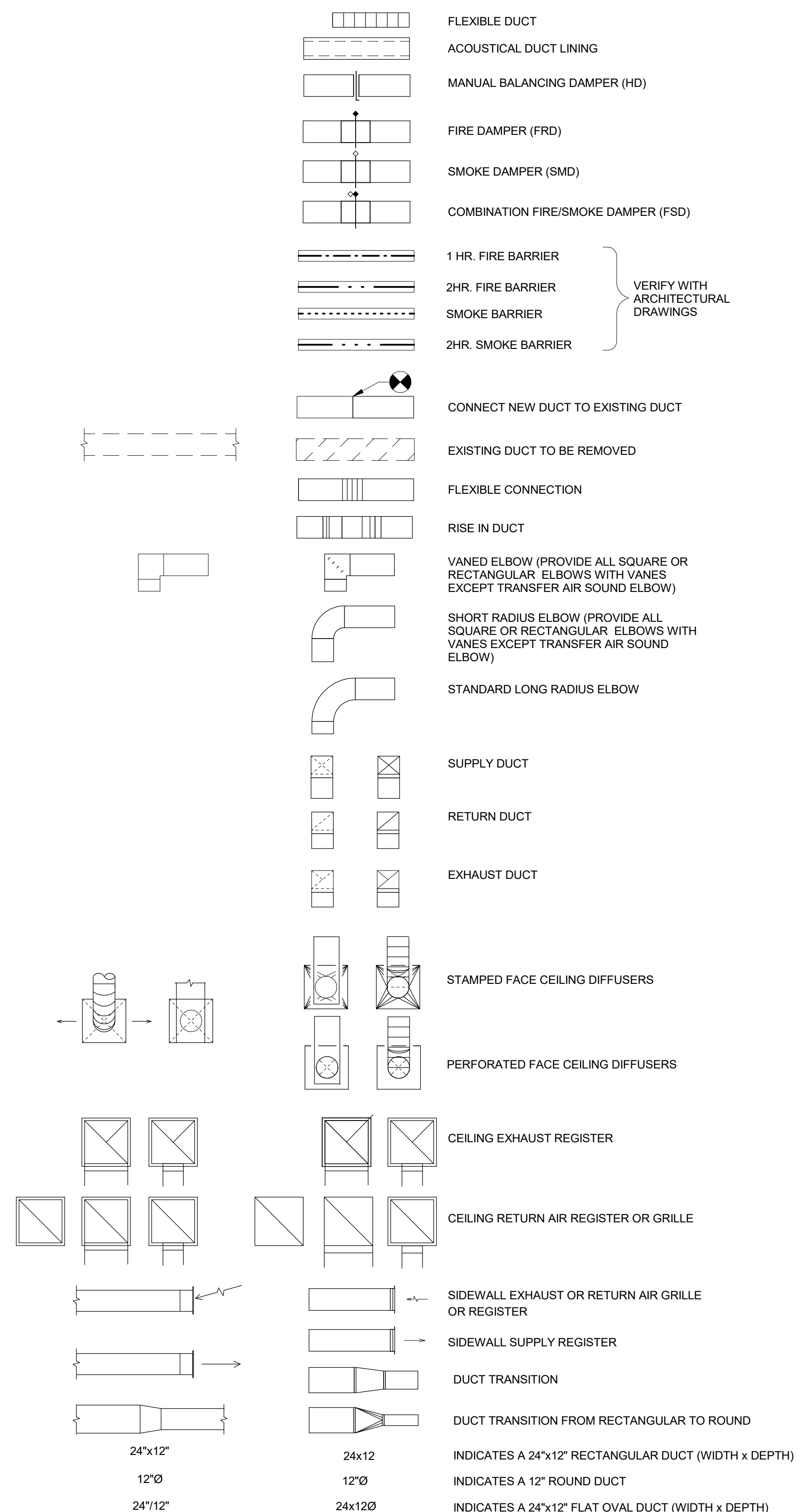

SECTION SYMBOL

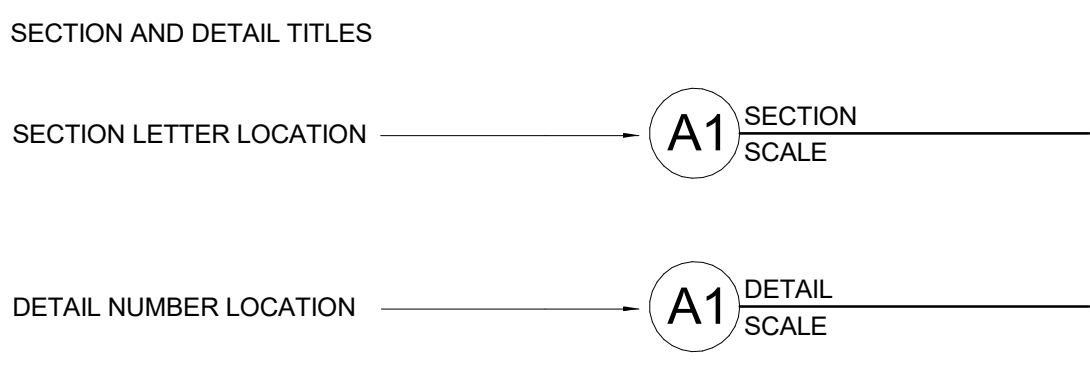
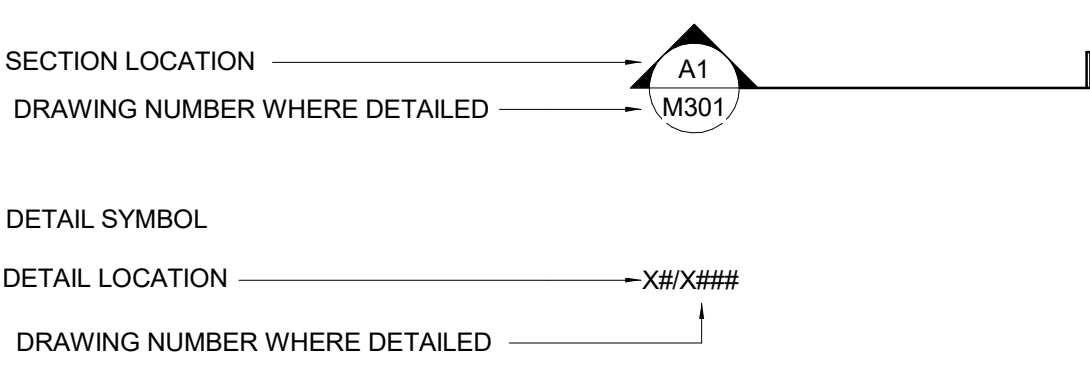

- EQUIPMENT SYMBOLS**
- LETTERS REFER TO THE EQUIPMENT TYPE
 - NUMBERS REFER TO SPECIFIC EQUIPMENT
 - SYMBOL INDICATES EQUIPMENT IDENTIFIED IN EQUIPMENT SCHEDULE
 - SIDEWALL GRILLE DIMENSION WHERE SHOWN ON PLANS
 - SYMBOL INDICATES GRILLE OR DIFFUSER IDENTIFIED IN EQUIPMENT SCHEDULE
 - CFM

NOTE: NOT ALL ABBREVIATIONS OR SYMBOLS APPLY TO THIS PROJECT

GENERAL NOTES

- ALL PIPING AND DUCTS IN FINISHED ROOMS OR SPACES SHALL BE CONCEALED IN FURRED CHASES OR SUSPENDED CEILINGS, UNLESS OTHERWISE NOTED.
- PROVIDE ACCESS PANELS OR DOORS IN INACCESSIBLE CEILINGS AND/OR CHASES FOR ALL VALVES, TRAPS, DAMPERS, CLEANOUTS, COILS, FANS, CONTROLS, ETC. THEY SHALL BE FURNISHED UNDER DIVISION 23 AND INSTALLED UNDER THE ARCHITECTURAL SPECIFICATION. ACCESS DOOR RATING SHALL MATCH CLASSIFICATION OF WALL AND CEILING FIRE RATING.
- COORDINATE THE LOCATION OF ALL DIFFUSERS, GRILLES, REGISTERS, ACCESS DOORS, ETC., WITH THE ARCHITECTURAL REFLECTED CEILING PLANS).
- ALL ROUND RUNOUTS AND DROPS TO DIFFUSERS SHALL BE THE SAME NOMINAL SIZE AS THE SCHEDULED DIFFUSER NECK SIZE.
- THE FIRST FIGURE OF DUCT SIZE INDICATES DIMENSION OF FACE SHOWN OR INDICATED. ALL DUCT SIZES SHOWN ON DRAWINGS ARE NET INSIDE DIMENSIONS. PROVIDE ONE INCH ACOUSTICAL LINING (TYPE D3 INSULATION) IN LOW VELOCITY RECTANGULAR DUCTWORK FOR THE FIRST 10 DIAMETERS OF DUCTWORK CONNECTED TO DEVICE, OR AS INDICATED ON DRAWINGS, WHICHEVER IS GREATER. FOR THE REMAINDER OF THIS DUCTWORK PROVIDE AS INDICATED IN THE INSULATION SPECIFICATIONS.
- PROVIDE TURNING VANES IN ALL SQUARE ELBOWS, EXCEPT TRANSFER AIR SOUND ELBOWS.
- REFER TO THE ARCHITECTURAL DRAWINGS FOR EXACT LOCATION OF ALL FIRE RATED AND/OR SMOKE RATED WALLS AND ASSEMBLIES. PROVIDE APPROVED FIRE DAMPERS IN ALL REQUIRED PENETRATIONS FOR DUCTWORK, GRILLES, REGISTERS AND DIFFUSERS. ALL PIPE AND DUCTWORK PENETRATIONS OF FIRE, SMOKE AND FULL HEIGHT WALLS SHALL BE CAULKED AIRTIGHT TO THE ADJACENT STRUCTURE BY MEANS OF U.L. APPROVED FIRE PROOF CAULKING MATERIAL.
- CONTRACTOR SHALL COORDINATE ALL DUCTWORK, PIPING, PLUMBING AND FIRE PROTECTION PIPING WITH STRUCTURAL AND ELECTRICAL SYSTEMS AND SHALL PROVIDE NECESSARY OFFSETS TO AVOID CONFLICTS AND TO MAINTAIN EQUIPMENT ACCESS AND SERVICEABILITY.
- CONTRACTOR SHALL FURNISH ALL NECESSARY STRUCTURES, INSERTS, SLEEVES, AND HANGING DEVICES FOR INSTALLATION OF MECHANICAL AND PLUMBING EQUIPMENT, DUCTWORK AND PIPING, ETC. CONTRACTOR SHALL COORDINATE WITH GENERAL CONTRACTOR AND ALL BUILDING TRADES TO AVOID CONFLICTS AND TO MAINTAIN EQUIPMENT ACCESS AND SERVICEABILITY.
- CONTRACTOR SHALL BE RESPONSIBLE FOR PROVIDING ALL NECESSARY MISCELLANEOUS ANGLES, CHANNELS, UNISTRUT, ETC., AS MAY BE REQUIRED TO ADEQUATELY SUPPORT THE MECHANICAL PIPING, DUCTWORK, AND EQUIPMENT IN A MANNER APPROVED BY THE ARCHITECT, WHICH WILL NOT OVERLOAD THE BUILDING STRUCTURAL SYSTEM.
- CONTRACTOR SHALL PROVIDE RETURN AIR OR TRANSFER AIR OPENINGS IN FULL HEIGHT WALLS SIZED AT 350 FPM (UNLESS OTHERWISE SPECIFICALLY SHOWN ON THE DRAWINGS) TO CREATE AND/OR MAINTAIN A RETURN AIR PATH AS REQUIRED. FIRE DAMPERS AND/OR SMOKE DAMPERS SHALL BE PROVIDED IN SUCH OPENINGS WHERE REQUIRED BY NOTE "J".
- SEAL ALL TRANSVERSE JOINTS, LONGITUDINAL SEAMS, DUCT WALL PENETRATIONS AND FITTING CONNECTIONS ON ALL DUCT SYSTEMS.
- MECHANICAL ITEMS SUCH AS ROOF DRAINS, FLOOR DRAINS, PLUMBING FIXTURES, ETC. SHOWN ON THE ARCHITECTURAL DRAWINGS BUT NOT SHOWN ON THE MECHANICAL DRAWINGS SHALL BE INCLUDED IN THE PROJECT. THESE ITEMS SHALL BE BROUGHT TO THE ATTENTION OF THE ARCHITECT FOR INCLUSION IN ADDENDUM.

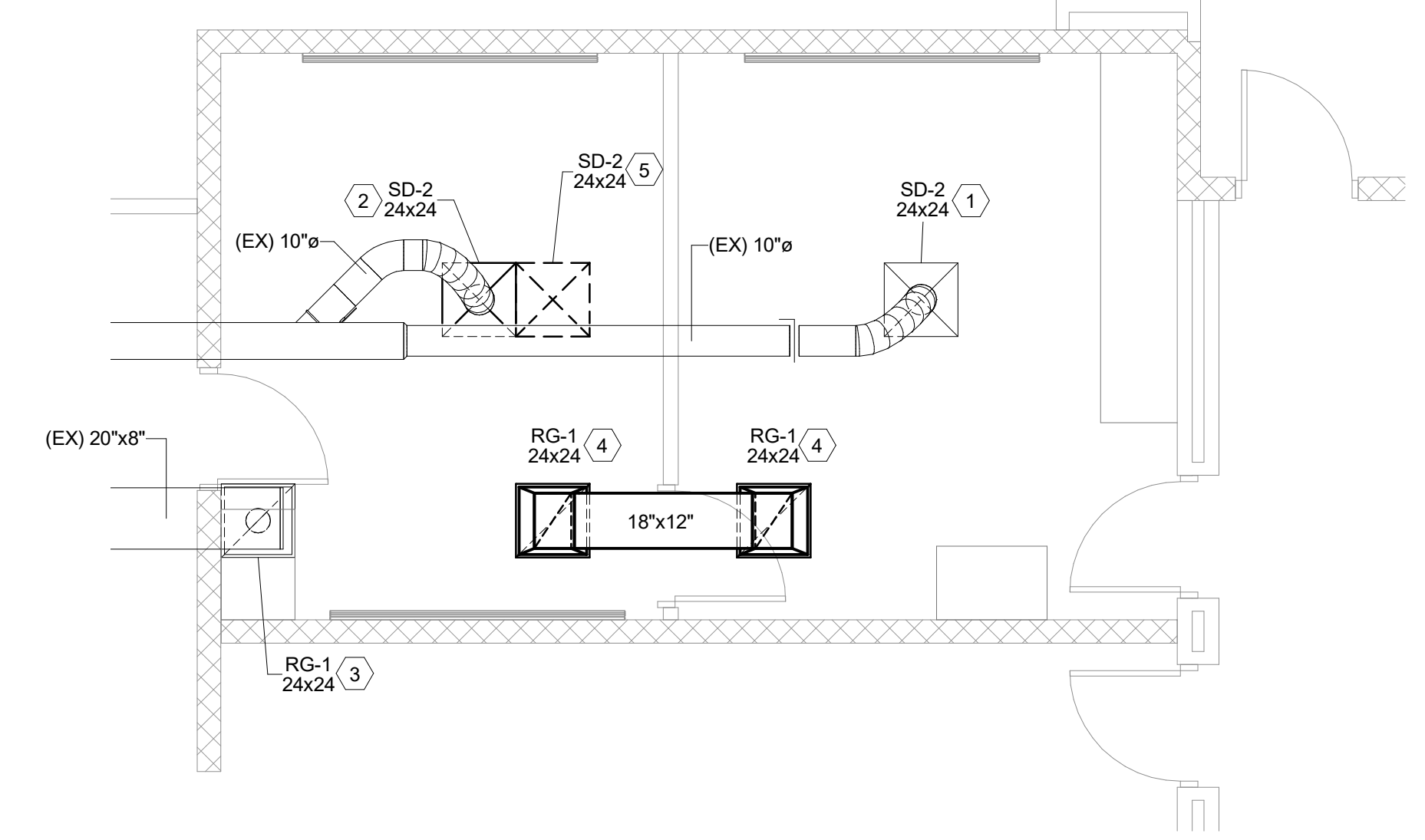

HVAC FIRST FLOOR PLAN



GENERAL SHEET NOTES		KEYNOTES	
A.	THIS DRAWING REFLECTS INFORMATION ON EXISTING BUILDING EQUIPMENT GATHERED FROM REVIEW OF RECORD CONSTRUCTION DRAWINGS AND FIELD INVESTIGATION. THE EXACT LOCATION, ARRANGEMENT, AND SIZES OF EQUIPMENT IN THE EXISTING BUILDING MAY BE DIFFERENT FROM THAT SHOWN ON THESE DRAWINGS. CONTRACTOR IS CAUTIONED TO INVESTIGATE EXISTING BUILDING CONDITIONS PRIOR TO SUBMITTING THEIR BIDS AND PROVIDE ALL REQUIRED FIELD MEASUREMENTS PRIOR TO PURCHASING NEW PIPING AND OTHER COMPONENTS AND DEVICES.	1.	EXISTING SUPPLY DIFFUSER TO REMAIN.
		2.	RELOCATED EXISTING SUPPLY DIFFUSER. REROUTE DUCT AS NECESSARY TO ALLOW FOR CONNECTIONS TO EXISTING SUPPLY DUCT.
		3.	EXISTING FILTER RETURN GRILLE TO REMAIN. PROVIDE NEW FILTER FOR GRILLE TO BE INSTALLED AFTER CONSTRUCTION.
		4.	NEW RETURN GRILLE. MATCH EXISTING RETURN GRILLE STYLE. SEE GRILLES, REGISTERS, AND DIFFUSERS SCHEDULE. GRILLE SHALL ALLOW TRANSFER AIR INTO ADJACENT SPACE TO BE RETURNED BY THE EXISTING RETURN GRILLE. DUCT SHALL BE ACOUSTICALLY LINED 1-1/2\"/>
		5.	EXISTING SUPPLY DIFFUSER TO BE RELOCATED AS SHOWN.

GRILLES, REGISTERS, AND DIFFUSERS										
TAG	COUNT	MANUFACTURER AND MODEL NO.	TYPE	FRAME STYLE	FACE SIZE	CONNECTION SIZE	CFM RANGE	TP (IN W.G.)	MAXIMUM INCH	NOTES
RG-1	3	PRICE 520	STEEL LOUVERED GRILLE	LAY-IN CEILING	24" x 24"	22"x22"	-	N/A	N/A	

D:\Revit\2018\Projects\0543_01_MEP Stratton Meadows Office_ghrooms\VP\UT.rvt 4/18/2019 4:19:04 PM Bridges & Paxton Project No. 8043.01